

## TimeHub 5500 Clock Streaker Card ST-TH5500 Practice

### CONTENTS:

1. GENERAL .....	1
2. APPLICATION .....	1
3. PROCEDURE .....	1
4. PHYSICAL DESCRIPTION/ WIRING .....	2
5. STEP by STEP TEST .....	3
PROCEDURE	
6. TEST CONDITIONS & .....	4
RESPONSES	
7. CONTINUITY TEST DATA.....	5
SHEET	

### 2 APPLICATION

The TimeHub 5500 Clock Streaker Card (ST-TH5500) provides a quick method to "streak"- verify wiring via LED's thru the TimeHub 5500 backplane to the Termination Points. The Streaker Card is utilized by installers and audit (acceptance) personnel.

*\* Note: The ST-TH5500 requires the STS-4 & Test Cord to operate properly. The unit will not operate alone.*

### 1 GENERAL

This practice provided by Telecom Assistance Group describes the TimeHub 5500 wiring verification method. This practice uses TAG's Streaker Card (ST-TH5500) along with the Test Sender Unit (STS-4).

### 3 PROCEDURE

The test procedure typically requires two (2) people for ease of testing. Tester 1 will observe the LED's at the front of the TimeHub 5500 Clock Streaker Card (ST-TH5500). Tester 2 will use TAG's Test Sender Unit (STS-4).

**CAUTION:** The ST-TH5500 should not be used in either slot if the group has been provisioned and is in service.)

See Page 3 for a Step-by-Step Test Procedure.

## TimeHub 5500 Clock Streaker Card ST-TH5500 Practice

### 4 Physical Description and Wiring

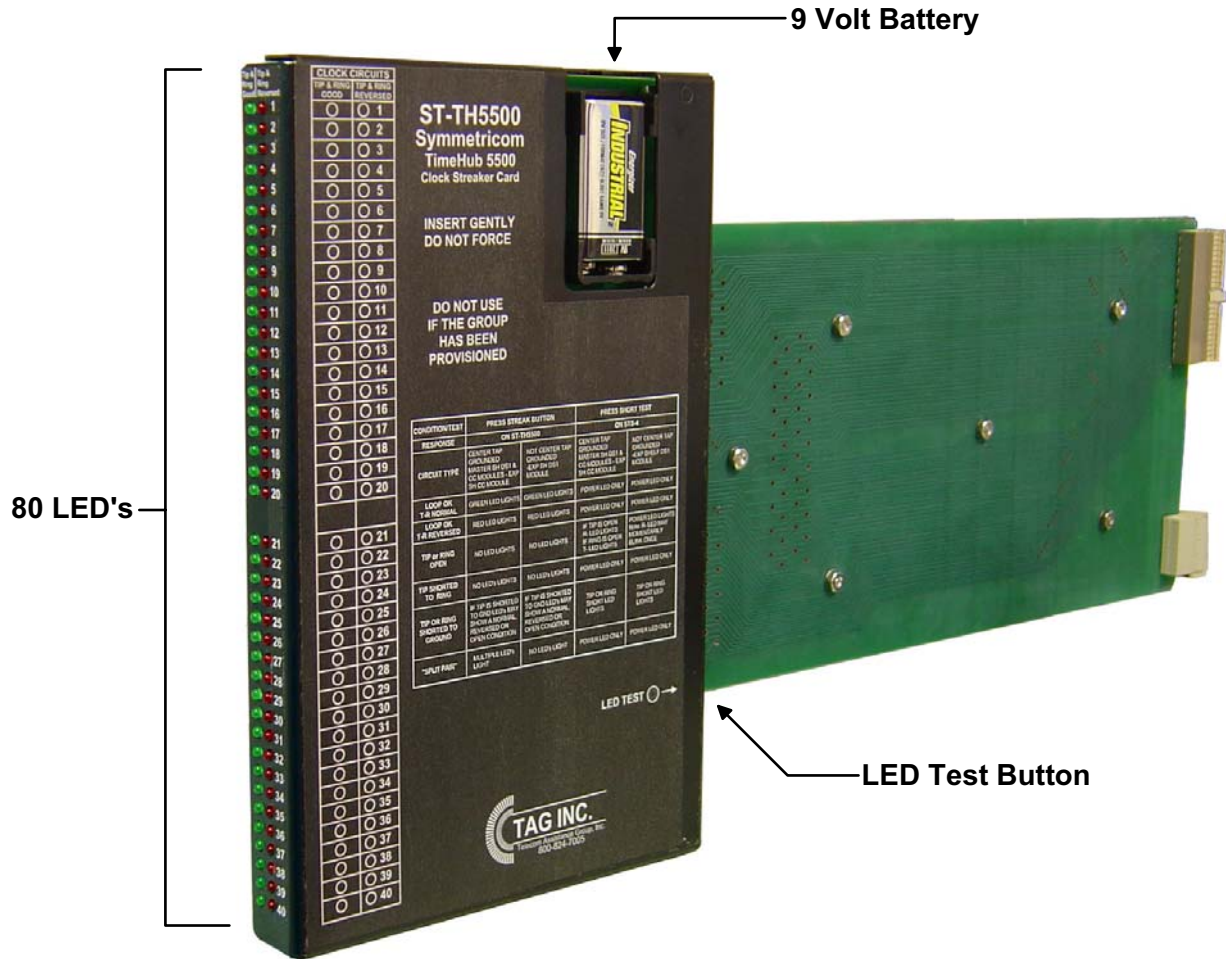

The TimeHub 5500 Clock Streaker Card (ST-TH5500) provides a quick method to "streak"- verify wiring via LED's thru the TimeHub 5500 backplane to the Termination Points. The Streaker Card is utilized by installers and audit (acceptance) personnel.

**\* Note: The ST-TH5500 requires the STS-4 & Test Cord to operate properly. The unit will not operate alone.**

## TimeHub 5500 Clock Streaker Card ST-TH5500 Practice

### 5 Step by Step Test Procedure

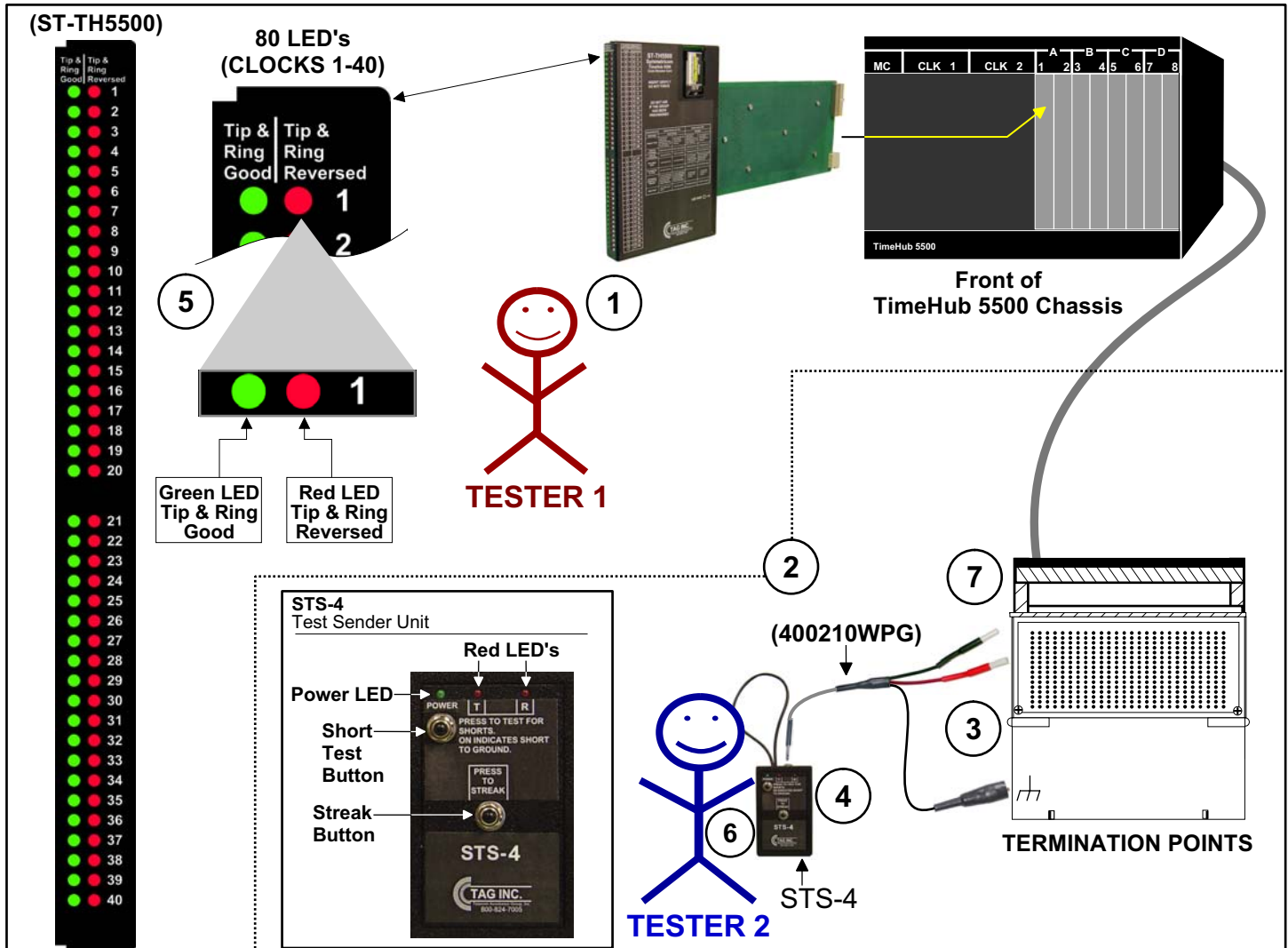

1. **Tester 1** will select a card slot & insert the TimeHub 5500 Clock Streaker Card (ST-TH5500) to begin testing. **(CAUTION: Do not force. Verify proper alignment before inserting.)**  
**(CAUTION: The ST-TH5500 should not be used if the group has been provisioned.)**
2. **Tester 1** will then establish communication with **Tester 2** at the Termination points.
3. **Tester 2** will connect the bantam to wire wrap gnd cord (400210WPG) from the Test Sender Unit (STS-4) to the Termination points (Tip-Black) & (Ring-Red) and connect the Alligator Clip to Frame Ground.
4. **Tester 2** will then press the Streak button on the STS-4.
5. **Tester 1** will observe the Green LED of Circuit 1 illuminating on the TimeHub 5500 Clock Streaker Card (ST-TH5500). See Table on Page 4 for all Test Conditions and Responses.
6. **Tester 2** will then press the Short button on the STS-4 and observe the Power LED illuminating. See Table on Page 4 for all Test Conditions and Responses.
7. **Tester 2** will move to the next set of Termination points (Tip & Ring) and repeat steps 4-6 for the rest of the remaining circuits.

## TimeHub 5500 Clock Streaker Card ST-TH5500 Practice

### 6 Test Conditions and Responses

	CONDITION/TEST	PRESS STREAK BUTTON		PRESS SHORT TEST	
	RESPONSE	ON ST-TH5500		ON STS-4	
	CIRCUIT TYPE	CENTER TAP GROUNDED MASTER SH DS1 & CC MODULES - EXP SH CC MODULE	NOT CENTER TAP GROUNDED -EXP SH DS1 MODULE	CENTER TAP GROUNDED MASTER SH DS1 & CC MODULES - EXP SH CC MODULE	NOT CENTER TAP GROUNDED -EXP SHELF DS1 MODULE
1	<b>LOOP OK T-R NORMAL</b>	GREEN LED LIGHTS	GREEN LED LIGHTS	POWER LED ONLY	POWER LED ONLY
2	<b>LOOP OK T-R REVERSED</b>	RED LED LIGHTS	RED LED LIGHTS	POWER LED ONLY	POWER LED ONLY
3	<b>TIP or RING OPEN</b>	NO LED LIGHTS	NO LED LIGHTS	IF TIP IS OPEN R- LED LIGHTS IF RING IS OPEN T- LED LIGHTS	POWER LED LIGHTS Note: R- LED MAY MOMENTARILY BLINK ONCE
4	<b>TIP SHORTED TO RING</b>	NO LED's LIGHTS	NO LED's LIGHTS	POWER LED ONLY	POWER LED ONLY
5	<b>TIP OR RING SHORTED TO GROUND</b>	IF TIP IS SHORTED TO GND LED's MAY SHOW A NORMAL, REVERSED OR OPEN CONDITION	IF TIP IS SHORTED TO GND LED's MAY SHOW A NORMAL, REVERSED OR OPEN CONDITION	TIP OR RING SHORT LED LIGHTS	TIP OR RING SHORT LED LIGHTS
6	<b>"SPLIT PAIR"</b>	MULTIPLE LED's LIGHT	NO LED's LIGHT	POWER LED ONLY	POWER LED ONLY

## TimeHub 5500 Clock Streaker Card ST-TH5500 Practice

### **7** Continuity Test Data Sheet

	Streaker Test (ST-TH5500)	Short Test (STS-4)
CK 1		
CK 2		
CK 3		
CK 4		
CK 5		
CK 6		
CK 7		
CK 8		
CK 9		
CK 10		
CK 11		
CK 12		
CK 13		
CK 14		
CK 15		
CK 16		
CK 17		
CK 18		
CK 19		
CK 20		

	Streaker Test (ST-TH5500)	Short Test (STS-4)
CK 21		
CK 22		
CK 23		
CK 24		
CK 25		
CK 26		
CK 27		
CK 28		
CK 29		
CK 30		
CK 31		
CK 32		
CK 33		
CK 34		
CK 35		
CK 36		
CK 37		
CK 38		
CK 39		
CK 40		